

NSB / NSR Series Versatile Screw Presenter

Swapping rails allows you to accommodate various screw diameters with a single unit. Almost no screw is incompatible.

| | | | |
|---------------------------------|--|--------------------------|---------------------------------|
| Supported diameter M1.0-M3.0 | Supported under-head length Longest: 20mm | Capacity Approx. 80cc | Non-ferrous materials supported |
|---------------------------------|--|--------------------------|---------------------------------|

*For details, please refer to each product's specifications.

| | |
|---------|----------|
| Manual | NSB NSBC |
| Robotic | NSR |



Ⓢ Screws are moved smoothly, and durability has been improved dramatically

< Improved screw chamber >
Reduces strain on the motor for more efficient screw alignment.

< Adjustable rail angle >
Allows the angle of rail inclination to be adjusted based on the screw being used.

< Amplitude adjustment >
Allows for calibrating amplitude based on the type of screw being used.

< No side-to-side vibration >
Alleviates side-to-side rail vibration to achieve smooth screw conveyance.

Ⓢ Other key features

- Compact size does not take up space.
- Use a screw hopper for higher capacity.
- The NSB type allows for a screw pick-up signal to be sent through an external outlet.
- The NSR type allows for the sending out of a signal to notify whether a screw is present at a screw pick-up point through an external outlet.

Ⓢ A single unit supports 8 different screw diameters.

- The NSB type supports 8 types of screw diameters through simple rail-swapping (8 types: from M1.0 to M3.0 by default).
- The NSR type supports this through simply swapping the rail and escaper. Clean up oil and other stains easily by removing the rail from behind.



NSB rail



NSR rails and escapers

Ⓢ One-touch rail-swapping

Swapping rails based on changes in screw diameter is easy (NSB type).



Manual Type



NSB

Robotic Type



NSR

With a Counter



NSBC

Compatibility Table

| Supported screw diameter (mm) | Main component type | | | Swap rail set type | | |
|-------------------------------|---------------------|------------|-------------|--------------------|------------|-------------|
| | NSB Series | NSR Series | NSBC Series | NSB Series | NSR Series | NSBC Series |
| 1.0 | NSB-10 | NSR-10 | NSBC-10 | SR10SET | SRR10SET | SR10SET |
| 1.2 | NSB-12 | NSR-12 | NSBC-12 | SR12SET | SRR12SET | SR12SET |
| 1.4 | NSB-14 | NSR-14 | NSBC-14 | SR14SET | SRR14SET | SR14SET |
| 1.7 | NSB-17 | NSR-17 | NSBC-17 | SR17SET | SRR17SET | SR17SET |
| 2.0 | NSB-20 | NSR-20 | NSBC-20 | SR20SET | SRR20SET | SR20SET |
| 2.3 | NSB-23 | NSR-23 | NSBC-23 | SR23SET | SRR23SET | SR23SET |
| 2.6 | NSB-26 | NSR-26 | NSBC-26 | SR26SET | SRR26SET | SR26SET |
| 3.0 | NSB-30 | NSR-30 | NSBC-30 | SR30SET | SRR30SET | SR30SET |

Model Diagrams

Full diagrams of each model can be downloaded from our website.

NSB Series

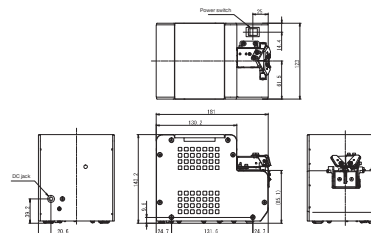

NSR Series

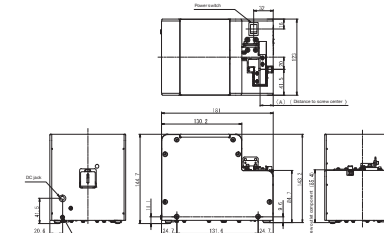

Specifications

| Model name | NSB | NSR | NSBC |
|--------------------------------------|--|---|--|
| Exterior dimensions | 123(W)×181(D)×145(H) | | |
| Volume (including the rail) | Approx. 2.9kgf | Approx. 3.0kgf | Approx. 2.9kgf |
| Power | AC100V – 240V DC15V 1A AC adapter | | |
| Drive motor | DC brush motor | | |
| Overload protection/recovery circuit | <input type="checkbox"/> | <input type="checkbox"/> | <input type="checkbox"/> |
| External signal line | <input type="checkbox"/> | <input type="checkbox"/> | <input type="checkbox"/> |
| Escaper electric break function | - | <input type="checkbox"/> | - |
| Yield time | - | Approx. 1.5sec | - |
| Supported screw diameter | M1.0-M3.0 | | |
| Supported screw under-head length | Up to 20 mm in length | | |
| Screw capacity | Approx. 80cc | | |
| Accessories and bundled items | Instruction manual, AC adapter, hex wrench, adjusting screwdriver, 0.35 mm gauge plate, earth wire | Instruction manual, AC adapter, hex wrench, adjusting screwdriver, earth wire | Instruction manual, AC adapter, hex wrench, adjusting screwdriver, 0.35 mm gauge plate, earth wire |