

SSI-M / SSI-R Series Slim Screw Presenter

Compact size supports a wide range of assembly workflows and fits anywhere

| | | | |
|---------------------------------|----------------------------------------------|--------------------------|----------------------------------|
| Supported diameter M1.0-M3.0 | Supported under-head length Longest: 16mm | Capacity Approx. 40cc | Non-ferrous materials: supported |
|---------------------------------|----------------------------------------------|--------------------------|----------------------------------|

*For details, please refer to each product's specifications.

| | | |
|---------|---------|---------|
| Manual | SSI-12M | SSI-23M |
| Robotic | SSI-12R | SSI-23R |



← 65mm → ← 65mm →

④ Slim, space-saving design

Compact, 65mm-wide design saves space.

④ Stable rail movement without clogging

Horizontal rail system prevents screws from clogging or overlapping, achieving stable presenting.

④ Integrated output designed for use with general counters

Send pick-up signal from output jack to connect a general-purpose counter.

Rear part description



← Frequency
← Vibration
← Timer

Calibrate screw feeding speed by frequency and vibration

SSI rear part

Escaper

- < High-speed screw supply >
Rotating escaper accurately separates screws and supplies them at a high speed.
- < Supports low-profile screws >
Supports screws with as low a profile as 0.35mm by default (or 0.2mm by special order).
- < Clogging-free mechanism >
Separates screws one at a time, ensuring they do not clog at the pick-up outlet.

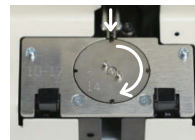

Rotating escaper

Manual Type



SSI-12M SSI-23M

Robotic Type



SSI-12R SSI-23R

Compatibility Table

| Supported screw diameter (mm) | Main component type | | Swap rail set type | |
|-------------------------------|---------------------|--------------|--------------------|--------------|
| | SSI-M Series | SSI-R Series | SSI-M Series | SSI-R Series |
| 1.0 | SSI-12M10 | SSI-12R10 | SIM10SET | SIR10SET |
| 1.2 | SSI-12M12 | SSI-12R12 | SIM12SET | SIR12SET |
| 1.4 | SSI-12M14 | SSI-12R14 | SIM14SET | SIR14SET |
| 1.7 | SSI-12M17 | SSI-12R17 | SIM17SET | SIR17SET |
| 2.0 | SSI-12M20 | SSI-12R20 | SIM20SET | SIR20SET |
| 2.3 | SSI-23M23 | SSI-23R23 | SIM23SET | SIR23SET |
| 2.6 | SSI-23M26 | SSI-23R26 | SIM26SET | SIR26SET |
| 3.0 | SSI-23M30 | SSI-23R30 | SIM30SET | SIR30SET |

Model Diagrams

Full diagrams of each model can be downloaded from our website.

SSI-M Series SSI-12M / SSI-23M

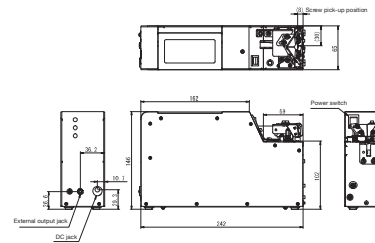

SSI-R Series SSI-12R / SSI-23R

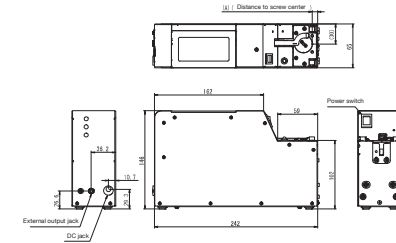

Specifications

| Model name | SSI-12M | SSI-23M | SSI-12R | SSI-23R |
|--------------------------------------|-------------------------------------------------------------------------------|-------------|-------------|-------------|
| Exterior dimensions | 65(W)×242(D)×146(H) | | | |
| Volume (including the rail) | Approx. 3.3kgf | | | |
| Power | AC100V - 240V DC15V 1A AC adapter | | | |
| Drive motor | DC brush motor, stepper motor | | | |
| Overload protection/recovery circuit | ○ | ○ | ○ | ○ |
| External outlet terminal | ○ | ○ | ○ | ○ |
| Escaper S-shape controlling function | ○ | ○ | ○ | ○ |
| Yield time | Approx. 0.9sec | | | |
| Supported screw diameter | M1.0 - M2.0 | M2.3 - M3.0 | M1.0 - M2.0 | M2.3 - M3.0 |
| Supported screw under-head length | Up to 16 mm in length | | | |
| Screw capacity | Approx. 40cc | | | |
| Accessories and bundled items | Instruction manual, AC adapter, hex wrench, adjusting screwdriver, earth wire | | | |