

BS Series

Pneumatic Screw Feeder

Pneumatically feeds screws to their destination in an instant.

Supported diameter	Supported under-head length	Capacity	For iron screws
M2.0-M6.0	Longest: 12/14/25mm	Approx. 80~1300cc	Non-ferrous materials supported

*For details, please refer to each product's specifications.

Manual	BS-D
Robotic	BS(S) BS(L) BS-P BS-R
Fixed-quantity pick up	BS-C

*BS-P irrespective of material / Other models only for iron screws

④ Uses air pressure to convey screws to distant locations

Brings screws right to you using air pressure, dramatically improving work efficiency.

*The default hose is 2.5 meters long and requires air tubing to be installed.

④ Space-saving, high-capacity model

Separating the screw feed from pick-up points allows for a space-saving design.

④ Four types based on different needs

BS (manual and robotic): Pneumatically feeds screws in response to an external signal.

BS-R (robotic pick up): Sliding unit conveys screws to screwdriver pneumatically, greatly cutting down on yield time.

BS-C (fixed-quantity bulk pick up): Pick up the set quantity with the counter and it allows for pick up by simply pulling the lever.

BS-D (fixed-quantity single pick up): Pick up the set number of screws and bolts one at a time next to your hand.

[BS]

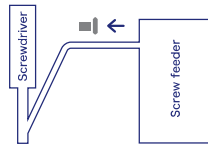

- Screws are pneumatically fed by request through an external signal.
- Screws are fed to the screwdriver's Y pipe with the screw side at the front.
- It is compatible with the robotic and manual screwdrivers.

[BS-C]

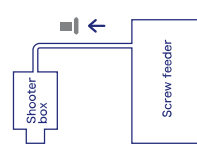

- Fixed quantities of screws are picked up in bulk.
- The screw feeder can be placed outside the workspace, saving more space for work.
- Fixed quantity pick up can prevent screw-tightening being forgotten.

[BS-R]

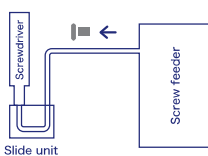

- Screws are pneumatically fed by request through an external signal.
- Placing the screw-feeding part of the slide unit near the screwdriver can shorten the time it takes to feed screws to the screwdriver.
- Screws are fed with the head at the front.
- It is compatible with screw-tightening robots.

[BS-D]

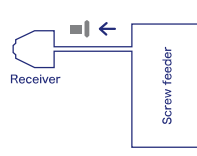

- Fixed quantities of screws are picked up one at a time.
- The screw feeder can be placed outside the workspace, saving space for work.
- It feeds the screw next to the hand doing the screw-tightening work.
- Fixed quantity pick up can prevent screw-tightening being forgotten.

Robotic Type



BS-P BS(S) BS(L)



BS-R

Manual Type



BS-D

With a Counter



BS-C

Compatibility Table

Supported screw diameter (mm)	Main component type					
	BS Series		BS-R Series	BS-D Series	BS-C Series	
	Scooping chamber capacity: approx. 280cc	Scooping chamber capacity: approx. 1300cc	-	-	Scooping chamber capacity: approx. 280cc	Scooping chamber capacity: approx. 1300cc
2.0	BS-S20	BS-L20	BS-R20	-	BS-CS20	BS-CL20
2.3	BS-S23	BS-L23	BS-R23	-	BS-CS23	BS-CL23
2.6	BS-S26	BS-L26	BS-R26	-	BS-CS26	BS-CL26
3.0	BS-S30	BS-L30	BS-R30	BS-D30	BS-CS30	BS-CL30
3.5	BS-S35	BS-L35	BS-R35	BS-D35	BS-CS35	BS-CL35
4.0	BS-S40	BS-L40	BS-R40	BS-D40	BS-CS40	BS-CL40
5.0	BS-S50	BS-L50	BS-R50	BS-D50	BS-CS50	BS-CL50
6.0	BS-S60	BS-L60	-	BS-D60	BS-CS60	BS-CL60

Model Diagrams

Full diagrams of each model can be downloaded from our website.

BS(S)/BS-C(S) Series

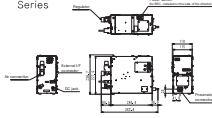

BS(L)/BS-C(L) Series

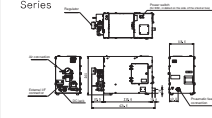

BS-C Series

Shooter box

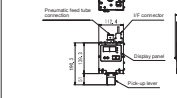

For BS-C (S) model diagrams, refer to BS.
For BS-C (L) model diagrams, refer to BS.

BS-R Series

Main component

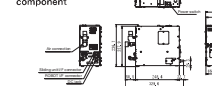

Slide unit

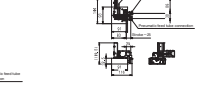

BS-D Series

Main component

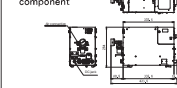

Receiver



Specifications

Model name	BS-S	BS-L	BS-CS	BS-CL	BS-D	BS-P	BS-R
Exterior dimensions	118(W)×310(D)×227(H)	169(W)×436(D)×270(H)	118(W)×310(D)×270(H)	169(W)×436(D)×270(H)	169(W)×436(D)×270(H)	175(W)×304(D)×186(H)	118(W)×310(D)×237(H)
Volume (including the rail)	Approx. 4kgf	Approx. 10kgf	Approx. 5kgf	Approx. 12kgf	Approx. 12kgf	Approx. 4kgf	Approx. 4.6kgf
Power	AC100V ~ 240V DC15V 1A AC adapter						
Air	0.5MPa MAX 40L/min						
Drive motor	DC brushless motor						
Pneumatic screw-feeding direction							
Overload protection/recovery circuit	○	○	○	○	○	○	○
External interface	○ (D-SUB 9pin)	○ (D-SUB 9pin)	-	-	-	○ (D-SUB 9pin)	○ (D-SUB 9pin)
Yield time	M5X25/3M Approx. 2 seconds by tube						
Supported screw diameter	M2.0 ~ M6.0				M3.0 ~ M6.0	M1.0 ~ M3.0	M2.0 ~ M5.0
Supported screw under-head length	Up to 25 mm in length				15 ~ 25 mm in length	Up to 12 mm in length	Up to 14 mm in length
Supported total length of screw	Length/head diameter ≥ 1.3 or more						
Screw capacity	Approx. 280cc	Approx. 1300cc	Approx. 280cc	Approx. 1300cc	Approx. 1300cc	Approx. 80cc	Approx. 280cc
Accessories and bundled items	Instruction manual, AC adapter, hex wrench, adjusting screwdriver, earth wire, pneumatic feed tube (2.5 meters)						
Accompanying unit	-	-	Shooter box Form : 113(W)×82(D)×140(H) Capacity: Approx. 20 for M5X25		Receiver Form : 30(W)×52(D)×120(H)		Slide unit Form : 116(W)×144(D)×120(H)

*Please inquire prior to placing an order.