

IT

Male Branch Tee

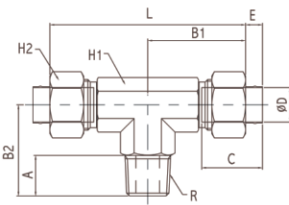

MODEL [ØD-T] Tube (Metric) – Thread (R)

MODEL	A	B1	B2	C	E	L	H1	H2	R	ØD	W.G(g)	Qty/Inbox
IT 04-02-01	11	20.05	19	13.6	4.55	40.1	10	10	R1/8	4.2	25	100
IT 04-02-02	12	22.05	22	13.6	4.55	44.1	12	10	R1/4	4.2	33	100
IT 06-04-01	11	20.3	19	13.8	4.5	40.6	10	12	R1/8	6.2	30	50
IT 06-04-02	12	22.3	22	13.8	4.5	44.6	12	12	R1/4	6.2	41	50
IT 06-04-03	13	27.3	28	13.8	4.5	54.6	14	12	R3/8	6.2	67	25
IT 08-05-01	11	23.2	21	15.6	4.4	46.4	12	14	R1/8	8.2	43	50
IT 08-05-02	12	23.2	22	15.6	4.4	46.4	12	14	R1/4	8.2	44	50
IT 08-05-03	13	28.2	28	15.6	4.4	56.4	14	14	R3/8	8.2	67	50
IT 08-06-01	11	23.2	21	15.6	4.4	46.4	12	14	R1/8	8.2	42	50
IT 08-06-02	12	23.2	22	15.6	4.4	46.4	12	14	R1/4	8.2	44	50
IT 08-06-03	13	28.2	28	15.6	4.4	56.4	14	14	R3/8	8.2	66	25
IT 10-6.5-02	12	28.9	27	17.8	4.9	57.8	14	17	R1/4	10.2	60	25
IT 10-6.5-03	13	28.9	28	17.8	4.9	57.8	14	17	R3/8	10.2	64	25
IT 10-6.5-04	18	29.7	32	17.8	4.9	59.4	18	17	R1/2	10.2	77	20
IT 10-08-02	12	28.9	27	17.8	4.9	57.8	14	17	R1/4	10.2	58	25
IT 10-08-03	13	28.9	28	17.8	4.9	57.8	14	17	R3/8	10.2	63	25
IT 10-08-04	18	29.7	32	17.8	4.9	59.4	18	17	R1/2	10.2	76	20
IT 12-08-02	12	29.4	27	18.8	5.4	58.8	14	19	R1/4	12.2	62	25
IT 12-08-03	13	29.4	28	18.8	5.4	58.8	14	19	R3/8	12.2	78	25
IT 12-08-04	18	30.2	32	18.8	5.4	60.4	18	19	R1/2	12.2	82	20
IT 12-09-02	12	29.4	27	18.8	5.4	58.8	14	19	R1/4	12.2	61	25
IT 12-09-03	13	29.4	28	18.8	5.4	58.8	14	19	R3/8	12.2	78	25
IT 12-09-04	18	30.2	32	18.8	5.4	60.4	18	19	R1/2	12.2	83	20
IT 16-11-03	13	38.3	29	23.3	5.5	72.6	18	27	R3/8	16.2	160	20
IT 16-11-04	18	38.3	34	23.3	5.5	72.6	18	27	R1/2	16.2	171	20

MODEL [ØD-T] Tube (Inch) – Thread (R)

MODEL	A	B1	B2	C	E	L	H1	H2	R	ØD	W.G(g)	Qty/Inbox
IT 1/4-01	11	20.3	19	13.8	4.5	40.6	10	12	R1/8	6.55	29	50
IT 1/4-02	12	22.3	22	13.8	4.5	44.6	12	12	R1/4	6.55	41	50
IT 1/4-03	13	27.3	28	13.8	4.5	54.6	14	12	R3/8	6.55	66	25
IT 5/16-01	11	23.2	21	15.6	4.4	46.4	12	14	R1/8	8.2	43	50
IT 5/16-02	12	23.2	22	15.6	4.4	46.4	12	14	R1/4	8.2	44	50
IT 5/16-03	13	28.2	28	15.6	4.4	56.4	14	14	R3/8	8.2	67	25
IT 3/8-02	12	28.7	27	17.8	5.1	57.4	14	17	R1/4	9.75	77	25
IT 3/8-03	13	28.7	28	17.8	5.1	57.4	14	17	R3/8	9.75	76	25
IT 3/8-04	18	29.5	32	17.8	5.1	59	18	17	R1/2	9.75	131	20
IT 1/2-02	12	29.5	27	18.8	5.3	59	14	19	R1/4	12.9	76	25
IT 1/2-03	13	29.5	28	18.8	5.3	59	14	19	R3/8	12.9	75	25
IT 1/2-04	18	30.35	32	18.8	5.3	60.7	18	19	R1/2	12.9	128	20

IUC

Union Straight

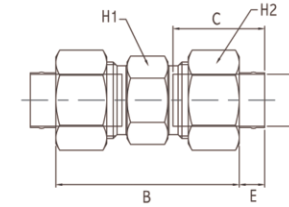

MODEL [ØD-T] Tube (Metric)

MODEL	B	C	E	H1	H2	ØD	W.G(g)	Qty/Inbox
IUC 04-02	31.1	13.6	4.55	10	10	4.2	13	100
IUC 06-04	31.6	13.8	4.5	10	12	6.2	20	50
IUC 08-05	33.4	15.6	4.4	12	14	8.2	25	50
IUC 08-06	33.4	15.6	4.4	12	14	8.2	28	50
IUC 10-6.5	35.8	17.8	4.9	15	17	10.2	40	50
IUC 10-08	35.8	17.8	4.9	15	17	10.2	39	50
IUC 12-08	36.8	18.8	5.4	17	19	12.2	46	25
IUC 12-09	36.8	18.8	5.4	17	19	12.2	48	25

MODEL [ØD-T] Tube (Inch)

MODEL	B	C	E	H1	H2	ØD	W.G(g)	Qty/Inbox
IUC 1/4	31.6	13.8	4.5	10	12	6.55	19	50
IUC 5/16	33.4	15.6	4.4	12	14	8.2	27	50
IUC 3/8	36.4	17.8	5.1	15	17	9.75	39	50
IUC 1/2	37.1	18.8	5.3	17	19	12.9	46	25

IUL

Union Elbow

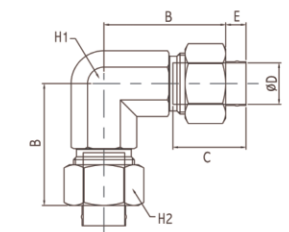
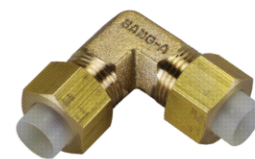

MODEL [ØD-T] Tube (Metric)

MODEL	B1	B2	C	E	H1	H2	ØD	W.G(g)	Qty/Inbox
IUL 04-02	20.05	20.05	13.6	4.55	10	10	4.2	28	100
IUL 06-04	20.3	20.3	13.8	4.5	10	12	6.2	25	50
IUL 08-05	23.2	23.2	15.6	4.4	12	14	8.2	40	50
IUL 08-06	23.2	23.2	15.6	4.4	12	14	8.2	41	50
IUL 10-6.5	29.9	29.9	17.8	4.9	14	17	10.2	73	25
IUL 10-08	29.9	29.9	17.8	4.9	14	17	10.2	76	25
IUL 12-08	30.9	30.9	18.8	5.4	14	19	12.2	84	25
IUL 12-09	30.9	30.9	18.8	5.4	14	19	12.2	85	25

MODEL [ØD-T] Tube (Metric)

MODEL	B1	B2	C	E	H1	H2	ØD	W.G(g)	Qty/Inbox
IUL 1/4	20.3	20.3	13.8	4.5	10	12	6.55	26	50
IUL 5/16	23.2	23.2	15.6	4.4	12	14	8.2	40	50
IUL 3/8	29.7	29.7	17.8	5.1	14	17	9.75	73	25
IUL 1/2	31.05	31.05	18.8	5.3	14	19	12.9	84	25