

**PUC-C**  
Union Straight

MODEL[ØD-T] Tube(Metric)-Thread(R)

MODEL	ØD	ØP	B	C	X	Y	Crifice (Ømm)	W.G(g)	Qty/Inbox
PUC 03C	3	6	20.4	9.5	7	6	2.5	1.1	100
PUC 04C	4	8	23.8	11.5	10	8	3	2	100
PUC 06C	6	10.5	25.1	12.5	12	10	4	3.2	100

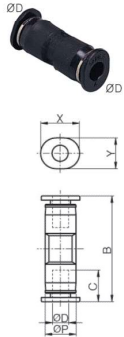

**PUL-C**  
Union Straight

MODEL[ØD-T] Tube(Metric)-Thread(R)

MODEL	ØD	ØP	Ød	C	F	B	X	Y	Crifice (Ømm)	W.G(g)	Qty/Inbox
PUL 03C	3	6	3.2	9.5	4.5	11.4	7	6	2.5	1.1	100
PUL 04C	4	8	3.2	11.5	5.8	13.9	10	8	3	2.1	100
PUL 06C	6	10.5	3.2	12.5	6.5	15.4	12	10	4	3.4	100

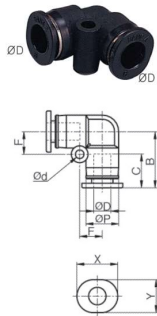

**PUT-C**  
Union Tee

MODEL[ØD-T] Tube(Metric)-Thread(R)

MODEL	ØD	ØP	Ød	F	C	B	X	Y	Crifice (Ømm)	W.G(g)	Qty/Inbox
PUT 03C	3	6	3.2	4.5	9.5	11.4	7	6	2.5	1.7	100
PUT 04C	4	8	3.2	5.8	11.5	13.9	10	8	3	3.1	100
PUT 06C	6	10.5	3.2	6.5	12.5	15.4	12	10	4	5	100

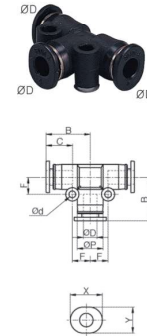

**PCF-C**  
Female Straight

MODEL[ØD-T] Tube(Metric)-Thread(R)

MODEL	ØD	Rc	G	C	A	B	H	ØP	X	Y	Crifice (Ømm)	W.G(g)	Qty/Inbox
PCF 03-M3C	3	M3	5	9.5	3	14.9	8	8	7	6	2	3.8	100
PCF 03-M5C	3	M5	5	9.5	5	16.9	8	8	7	6	2.5	4.1	100
PCF 04-M3C	4	M3	5	11.5	3	15	8	8	10	8	2	3.7	100
PCF 04-M5C	4	M5	5	11.5	5	17	8	8	10	8	2.5	3.8	100

