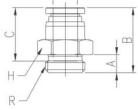

GPC-G
Male Straight

MODEL [ØD-T] Tube (Metric) - Thread (G)

MODEL	ØD	R	A	B	C	H1	H2	X	Y	Orifice (mm)	W.G(g)	Qty./Inbox
GPC 04G01	4	G1/8	5	18.4	14.5	13	3	8.6	10.8	3	8.4	100
GPC 04G02	4	G1/4	6	18.1	14.5	16	3	8.6	10.8	3	14.3	100
GPC 04G03	4	G3/8	7	18.1	14.5	20	3	8.6	10.8	3	24.1	50
GPC 06G01	6	G1/8	5	23.1	15.5	13	4	11	13	4	10.7	100
GPC 06G02	6	G1/4	6	19.8	15.5	16	4	11	13	4	14.2	100
GPC 06G03	6	G3/8	7	18.8	15.5	20	4	11	13	4	23.1	50
GPC 06G04	6	G1/2	8.5	19.3	15.5	24	4	11	13	4	42.9	50
GPC 08G01	8	G1/8	5	26	17.8	13	5	13	15	5	12.5	50
GPC 08G02	8	G1/4	6	21.7	17.8	16	6	13	15	6	14.1	50
GPC 08G03	8	G3/8	7	22.7	17.8	20	6	13	15	6	25.1	50
GPC 08G04	8	G1/2	8.5	23.7	17.8	24	6	13	15	6	41.9	50
GPC 10G01	10	G1/8	5	27.6	19.4	16	5	16	18.5	5	18.0	50
GPC 10G02	10	G1/4	6	28.3	19.4	16	6	16	18.5	6	20.7	50
GPC 10G03	10	G3/8	7	24.3	19.4	20	8	16	18.5	8	22.6	50
GPC 10G04	10	G1/2	8.5	24.8	19.4	24	8	16	18.5	8	39.9	50
GPC 12G01	12	G1/8	5	31.7	22.4	19	5	19.5	22.5	5	29.1	50
GPC 12G02	12	G1/4	6	32.4	22.4	19	6	19.5	22.5	6	32.3	50
GPC 12G03	12	G3/8	7	32.4	22.4	20	9	19.5	22.5	9	33.5	50
GPC 12G04	12	G1/2	8.5	28.9	22.4	24	10	19.5	22.5	10	41.1	25
GPC 14G03	14	G3/8	7	34.5	24.4	22	9	23	25	9	46.6	25
GPC 14G04	14	G1/2	8.5	36	24.4	24	11	23	25	11	57.0	25
GPC 16G03	16	G3/8	7	35.5	25	24	9	24	27	9	51.5	25
GPC 16G04	16	G1/2	8.5	36.5	25	24	11	24	27	11	56.9	25

MODEL [ØD-T] Tube (Metric) - Thread (G)

MODEL	ØD	R	ØP	A	B	C	E	F	H	X	Y	Orifice (mm)	W.G(g)	Qty./Inbox
GPL 04G01	4	G1/8	9	5	14.6	14.5	17.1	4.5	13	8.6	10.8	3.2	8.0	100
GPL 04G02	4	G1/4	9	6	15.3	14.5	17.1	4.5	16	8.6	10.8	3.2	13.4	100
GPL 04G03	4	G3/8	9	7	16.8	14.5	17.1	5	20	8.6	10.8	3.2	22.4	50
GPL 06G01	6	G1/8	11.2	5	15.7	15.5	18	4.5	13	11	13	4	8.8	100
GPL 06G02	6	G1/4	11.2	6	16.4	15.5	18	4.5	16	11	13	4	14.2	50
GPL 06G03	6	G3/8	11.2	7	17.9	15.5	18	5	20	11	13	4	23.2	50
GPL 06G04	6	G1/2	11.2	8.5	19.9	15.5	18	5.5	24	11	13	4	39.3	25
GPL 08G01	8	G1/8	13.6	5	19.6	17.8	23.6	7	13	13	15	5.5	13.3	50
GPL 08G02	8	G1/4	13.6	6	17.8	17.8	23.6	4.5	16	13	15	5.5	16.0	50
GPL 08G03	8	G3/8	13.6	7	18.8	17.8	23.6	4.5	20	13	15	5.5	24.1	50
GPL 08G04	8	G1/2	13.6	8.5	20.8	17.8	23.6	5	24	13	15	5.5	39.8	25
GPL 10G01	10	G1/8	16.3	5	21.9	19.4	25	5.5	15	16	18.5	6	16.3	50
GPL 10G02	10	G1/4	16.3	6	22.6	19.4	25	7.5	16	16	18.5	8	20.1	25
GPL 10G03	10	G3/8	16.3	7	21.1	19.4	25	5	20	16	18.5	9	23.5	25
GPL 10G04	10	G1/2	16.3	8.5	22.6	19.4	25	5	24	16	18.5	9	38.6	25
GPL 12G01	12	G1/8	19.7	5	23.8	22.4	32.2	5.5	15	19.5	22.5	6	21.9	25
GPL 12G02	12	G1/4	19.7	6	24.5	22.4	32.2	7.5	16	19.5	22.5	8	25.8	25
GPL 12G03	12	G3/8	19.7	7	23	22.4	32.2	5	20	19.5	22.5	9.5	29.2	25
GPL 12G04	12	G1/2	19.7	8.5	24.5	22.4	32.2	5	24	19.5	22.5	9.5	44.2	25
GPL 14G03	14	G3/8	23.5	7	30.5	24.4	31.9	11	20	23	25	11.5	45.0	20
GPL 14G04	14	G1/2	23.5	8.5	26	24.4	31.9	5	24	23	25	12	44.6	20
GPL 16G03	16	G3/8	25.6	7	31.5	25	34	11	20	24	27	11.5	45.2	20
GPL 16G04	16	G1/2	25.6	8.5	27	25	34	5	24	24	27	13	44.8	20

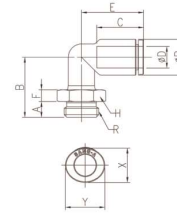
GPL-G(L)
Male Elbow

MODEL [ØD-T] Tube (Metric) - Thread (G)

MODEL	ØD	R	ØP	A	B	C	E	F	H	X	Y	Orifice (mm)	W.G(g)	Qty./Inbox
GPL 04G01(L)	4	G1/8	9	5	17.8	14.5	17.1	4.5	13	8.6	10.8	3.2	7.3	100
GPL 04G02(L)	4	G1/4	9	6	18.5	14.5	17.1	4.5	16	8.6	10.8	3.2	12.2	100
GPL 04G03(L)	4	G3/8	9	7	20	14.5	17.1	5	20	8.6	10.8	3.2	20.4	50
GPL 06G01(L)	6	G1/8	11.2	5	19.5	15.5	18	4.5	13	11	13	4	8.3	100
GPL 06G02(L)	6	G1/4	11.2	6	20.1	15.5	18	4.5	16	11	13	4	13.2	50
GPL 06G03(L)	6	G3/8	11.2	7	21.6	15.5	18	5	20	11	13	4	21.4	50
GPL 06G04(L)	6	G1/2	11.2	8.5	23.6	15.5	18	5.5	24	11	13	4	36.0	25
GPL 08G01(L)	8	G1/8	13.6	5	24.6	17.8	23.6	7	13	13	15	5.5	11.9	50
GPL 08G02(L)	8	G1/4	13.6	6	22.8	17.8	23.6	4.5	16	13	15	5.5	14.4	50
GPL 08G03(L)	8	G3/8	13.6	7	23.8	17.8	23.6	4.5	20	13	15	5.5	21.7	50
GPL 08G04(L)	8	G1/2	13.6	8.5	25.8	17.8	23.6	5	24	13	15	5.5	36.0	25
GPL 10G01(L)	10	G1/8	16.3	5	28	19.4	25	5.5	15	16	18.5	6	15.4	50
GPL 10G02(L)	10	G1/4	16.3	6	28.7	19.4	25	7.5	16	16	18.5	8	18.9	25
GPL 10G03(L)	10	G3/8	16.3	7	27.2	19.4	25	5	20	16	18.5	9	22.0	25
GPL 10G04(L)	10	G1/2	16.3	8.5	28.7	19.4	25	5	24	16	18.5	9	35.7	25
GPL 12G01(L)	12	G1/8	19.7	5	29.7	22.4	32.2	5.5	15	19.5	22.5	6	20.5	25
GPL 12G02(L)	12	G1/4	19.7	6	30.4	22.4	32.2	7.5	16	19.5	22.5	8	24.5	25
GPL 12G03(L)	12	G3/8	19.7	7	28.9	22.4	32.2	5	20	19.5	22.5	9.5	27.1	25
GPL 12G04(L)	12	G1/2	19.7	8.5	30.4	22.4	32.2	5	24	19.5	22.5	9.5	40.8	25

MODEL [ØD-T] Tube (Metric) - Thread (G)

MODEL	ØD	R	ØP	A	B	C	E	H	G	X	Y	Orifice (mm)	W.G(g)	Qty./Inbox
GPL45 04G01	4	G1/8	9	5	13.1	14.5	17.1	13	28.1	8.6	10.8	3.2	7.3	100
GPL45 04G02	4	G1/4	9	6	13.8	14.5	17.1	16	28.8	8.6	10.8	3.2	12.2	100
GPL45 04G03	4	G3/8	9	7	15.3	14.5	17.1	20	30.3	8.6	10.8	3.2	20.4	50
GPL45 06G01	6	G1/8	11.2	5	13.7	15.5	18	13	30.1	11	13	4	8.1	100
GPL45 06G02	6	G1/4	11.2	6	14.4	15.5	18	16	30.8	11	13	4	13.0	50
GPL45 06G03	6	G3/8	11.2	7	15.9	15.5	18	20	32.3	11	13	4	21.2	50
GPL45 06G04	6	G1/2	11.2	8.5	17.9	15.5	18	24	34.3	11	13	4	35.8	50
GPL45 08G01	8	G1/8	13.6	5	16.8	17.8	23.6	13	37.9	13	15	5.5	11.4	50
GPL45 08G02	8	G1/4	13.6	6	15	17.8	23.6	16	36.1	13	15	5.5	13.9	50
GPL45 08G03	8	G3/8	13.6	7	16	17.8	23.6	20	37.1	13	15	5.5	21.2	50
GPL45 08G04	8	G1/2	13.6	8.5	18	17.8	23.6	24	39.1	13	15	5.5	35.5	25
GPL45 10G01	10	G1/8	16.3	5	17.9	19.4	25	15	41	16	18.5	6	17.0	25
GPL45 10G02	10	G1/4	16.3	6	18.6	19.4	25	16	41.7	16	18.5	8	20.5	25
GPL45 10G03	10	G3/8	16.3	7	17.1	19.4	25	20	40.2	16	18.5	9	23.6	25
GPL45 10G04	10	G1/2	16.3	8.5	18.6	19.4	25	24	41.7	16	18.5	9	37.3	25
GPL45 12G01	12	G1/8	19.7	5	19.4	22.4	32.2	15	48.7	19.5	22.5	6	19.5	25
GPL45 12G02	12	G1/4	19.7	6	20.1	22.4	32.2	16	49.4	19.5	22.5	8	23.0	25
GPL45 12G03	12	G3/8	19.7	7	18.6	22.4	32.2	20	47.9	19.5	22.5	9.5	26.1	25
GPL45 12G04	12	G1/2	19.7	8.5	20.1	22.4	32.2	24	49.4	19.5	22.5	9.5	39.8	25

GPL45-G
Male 45° Elbow